

LED half round neon strip manual

1.



WARNING !

- The following safety precautions are intended to prevent any injury or damage to other things, and may cause damage if the product violates precautions during use.
- 1、 Installation and inspection of the product must be carried out by a professional with an electrician's certificate.
 - 2、 Please use DC24V power supply. Please insure right positive and negative connection Do not use other power sources, such as AC220-240V.
 - 3、 All power cables should be with protection treatment. The power supply wiring should be insulated and waterproof.
 - 4、 The product should not be covered thermal insulation material or inflammables, which may cause the product to malfunction or catch fire.
 - 5、 The installation must be firm, without loosening, sagging, etc., and the product cannot be moved forcibly after installation.
 - 6、 For safety, do not look directly at the LED light source.
 - 7、 Do not use as task illumination when in building construction.
 - 8、 LED module can't be changed.

PRECAUTIONS

- Precautions for storage:
- 1、 storage temperature and humidity: 0℃-55℃ 40-70%RH
 - 2、 Do not unwarp packaging during storage. Please place in the direction indicated by the carton. Do not stack heavy objects on the packing box.
 - 3、 Please do not store the product under the following conditions:
 - High humidity
 - High temperature
 - confetti and dust
 - sunlight exposed
 - Chemicals such as strong acids, strong bases, solvents, etc

- Precautions for installation and use:
- 1、 Install in strict accordance with the instructions.
 - 2、 temperature of product use: -10℃-+40℃. Do not use under the following conditions:
 - High temperature
 - high humidity,
 - dust,
 - sun exposure,
 - strong acid and strong alkali solvents,
 - >2000 meters high altitude,
 - high air pressure,
 - electromagnetic influence,
 - places that may cause vibration or fall
 - 3、 Random cutting, breakage, forcibly pull, twist, press and tag on the product is prohibited.

2.

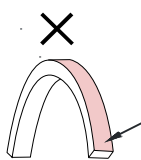

Image 1

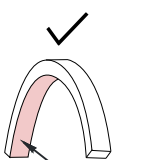

Image 2

When bending radius of the strip is $\geq 100\text{mm}$, do not bend the strip with less than the radius.

When the twist length is $\geq 500\text{mm}$, the twist angle can be 360° . When the length is less than 500mm, the strip can't be twisted.

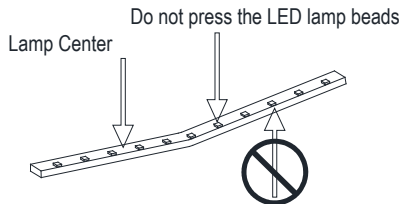

Image 3

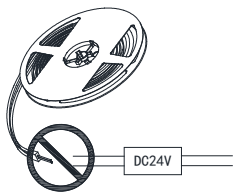

Image 4

I Mounting

1、PC Profile Mounting

- 402135 PC Profile
Preset the profile onto the installation spot with screws supplied, then insert the LED Strip into the profile

3.

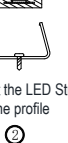
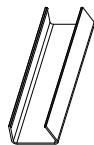

2、Mounting Clip

- 402134 Clips
Fix the mounting clips with screws supplied (3 clips per meter), insert the LED Strip into the clips



II Cutting

1、If you need to cut, the method is as follows:

- ① Cut strip lights to desired length at the designated cut points
 - ② Dotted Line
 - ③ End Connector After Cutting
- Apply the silicone adhesive evenly to the cut ends (including the pipes) that need to be covered by the plug, cover the plug after completion, and power after 2 hours of glue injection.

4.

III Power Supply Installation and Wiring

Installing DC 24V power supply

Notice on Power Supply:
Select the right IP rating power supply according to the actual use environment

⑥ DC24V power supply
L N 0 + - -
②
④ Wiring according to the mark
③
①
⑤
Do not reverse polarity when connecting and do insulation
Power on after confirming all connection is in good condition

Installation Steps:
1、 Install the strip light
2、 Install the power supply
3、 Connect strip light with DC 24V power supply
4、 Connect DC 24V power supply with mains supply
5、 Double check
6、 Power on

Note on Power Supply Installation:
-Turn off the power before installing the power supply
-Make sure the power supply is firmly fixed
-Wiring according to the mark or the terminal
-Do not reverse polarity when connecting.
-Make sure all connections are in good contact
-All connections need to be insulated
-It is recommended to reserve at least 20% of the power supply
-Non-isolated power supplies cannot be used

Wiring Illustration for Connection over 5m---Installation A

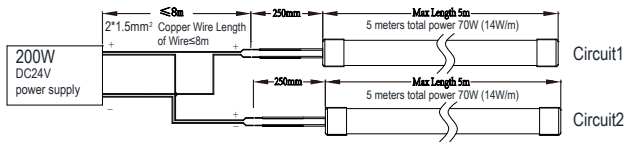

- Note:
- 1、 It is recommended to reserve 20% of the power supply. As shown, with 200W power supply, and 14W/m strip, the actual load is rounded to 10 meters instead of 11 meters.
 - 2、 The maximum connection length of the light strip is 5 meters

As shown, there are a total of 10 meters, and the light strips exceeding 5 meters should be led separately from the driver (divided into 2 circuits and lead separately)

Wiring Illustration for Connection over 5m---Installation B

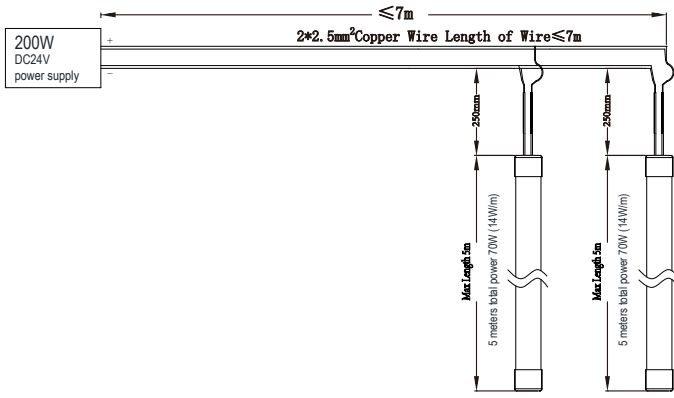

- Note:
- 1、 It is recommended to reserve 20% of the power supply. As shown, with 200W power supply, and 14W/m strip, the actual load is rounded to 10 meters instead of 11 meters.
 - 2、 The maximum connection length of the light strip is 5 meters

As shown, there are a total of 10 meters, and the light strips exceeding 5 meters should be connected to the main line separately.

Maintenance

- to ensure the stable use of the product and prolong its service life, regular inspection and cleaning is needed
- Cleaning and inspection at least every 3 months with power off

Inspection Method

- Whether driver and chips work well
- Whether there is unusual smell, sound or heat.
- Whether there are breakage, or looseness, etc. If an abnormality is found, please immediately power off and stop using, and eliminate the abnormality in time.

Cleaning

- Gently wipe the product with a soft cloth.