

POYO

Installation instructions

Series	Cut-out	Series	Cut-out
DR00801	Ø85mm	DR00802	Ø85mm
DR00803	Ø120mm	DR00804	Ø120mm

I、 Installation steps:

1 Cut a hole corresponding to the model in the ceiling (suitable for ceiling thickness 8-20mm)

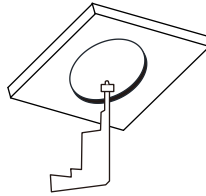

2 Connect the driver to mains supply with power off (please connect to adaptive constant current driver when there is not)

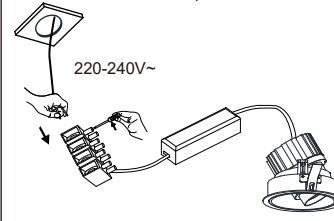

3 Put the driver into the ceiling

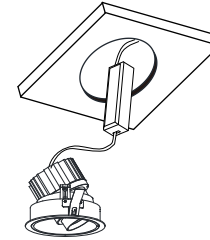

4 Press shrapnels to install the light

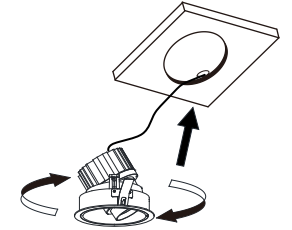

The actual appearance shall prevail in kind!

1.

2.

3.

II、LED module replacement

Optical accessories: honeycomb louver, cross louver, soft lens

- 1** Remove the anti-glare ring counterclockwise with power off

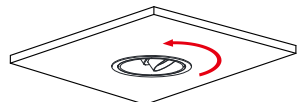

Rotate the anti-glare ring counterclockwise

- 2** Replace the required optical accessories

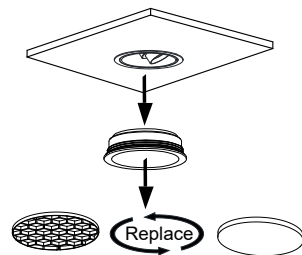

Replace

- 3** Tighten the anti-glare ring clockwise to complete the replacement.

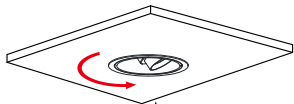

Rotate the anti-glare ring clockwise

4.

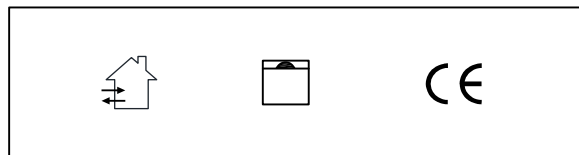

Suitable for indoor environment and specific outdoor environment



Independent external driver, recessed mounted.

5.

Do not clean LED chip and reflector with hand or towel !



- Use only drivers that comply with IEC or CE safety standards.
- Check if the power supply match with the luminaire.
- Must consider the maximum current value displayed on the label of the luminaire.
- The voltage displayed on the luminaire is not used to select the constant voltage driver, but the voltage covered by the selected constant current driver.
- Take suitable ESD measures to avoid touching bare conductors.
- LED chips can be damaged if be in touch with chemical material or gas. Therefore, it is not allowed to clean the LED housing or luminaire by chemicals.
- The following items are confirmed to have negative impact on the performance of the luminaire, avoid to keep luminaire in the same circumstance with them.
 - Methyl acetate or ethyl acetate (i.e., nail polish remover)
 - Cyanoacrylates (i.e., "Superglue")
 - Glycol ethers (including Radio Shack @ Precision Electronics Cleaner - dipropylene glycol monomethyl ether)
 - Formaldehyde or butadiene (including Ashland PLIOBOND @ adhesive)
 - Dymax 984-LVUF conformal coating
 - Loctite Sumo Glue - Loctite 384 adhesive - Loctite 7387 activator
 - Gorilla Glue - Bleach, Bleach-containing cleaners, sprays
- Remove the insulation material from the luminaire or provide enough space so that the temperature raising will not overpass the limited TC.
- LED chip is very sensitive to switching transients, therefore, LED lamps and appliances must be connected after power cut off, no hotswappable.
- Recommends using the driver indicated on the luminaire manual.
- Must consider the polarity of the product.
- If the external flexible cable or cord of this lamp is damaged, the cord should be replaced by the manufacturer or its service agent or a similarly qualified person
- The light source in this lamp should be replaced by the manufacturer or its service agent or a similarly qualified person

6.