

MIZAR 52

Mizar52 surface-mounted
series installation instructions

SERIES	LONG	SERIES	LONG
LS00201	0.25m	LS00202	0.25m
	0.5m		0.5m
	1.0m		1.0m

Installation Instructions:

1 Press down the connection pedestal with hand, intert L/N earth wire of main supply to the correct hole; make the lead intert the corresponding 3PCS holes and out the power line If need to joint the another lamp.

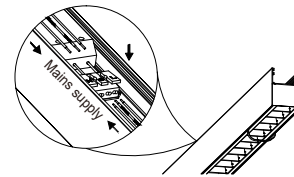

2 Hold the grip and pull out reflector, take down the grip and put it into the trash can.

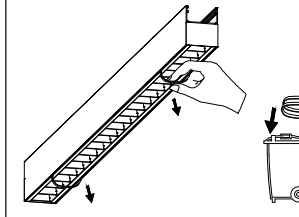

3 Use the accessories bag screw alignment at the hole besides the fuxture, fix the fitting on the ceiling and put the reflector into the trench.

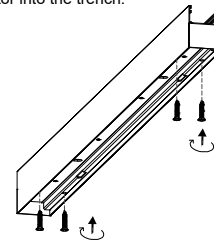

4 Install the reflector.

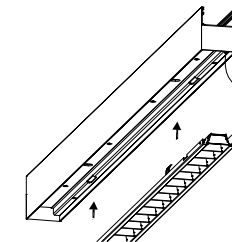

The specific appearance is subject to the real product!

Splicing method:

Straight line splicing:

After the first luminaire is installed put the positioning bracket into the slot, fix the positioning bracket with screws, then connect the second luminaire with the first one together.

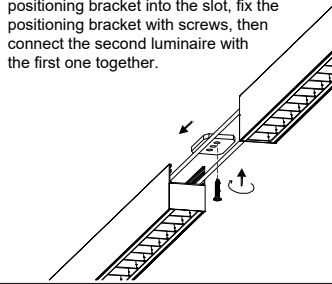

1 L type splicing:

Install the first luminaire and fix the L type positioning bracket with screws. Install the second luminaire into to L type bracket, fix the luminaire and connect the wires.

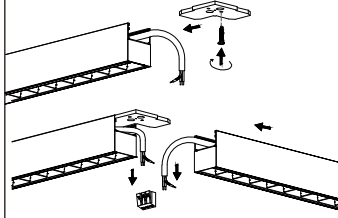

2 L type splicing:

Torn off the two piece sheets of the connector that the wires will through, and then connected the wires in the connector, fix the connector with screws.

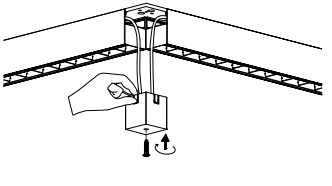

3 L type splicing:

Take off the end cover of the last luminaire, and fix the plug in the accessories package to the luminaire.

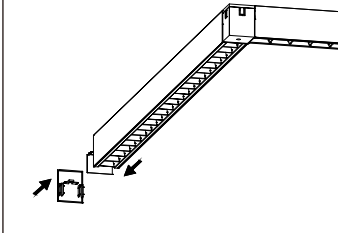

Notice:

- 1、 Please operate the wire connection, luminaire installation under the condition of power off.
- 2、 The maximum total length of the splicing shall not exceed 10 meters.
- 3、 T-shaped splicing, cross-shaped splicing can be spliced in L-shaped splicing.
- 4、 The specific appearance is subject to the real product!

3.

Do not clean LED chip and reflector with hand or towel !



- Use only drivers that comply with IEC or CE safety standards.
- Check if the power supply match with the luminaire.
- Must consider the maximum current value displayed on the label of the luminaire.
- The voltage displayed on the luminaire is not used to select the constant voltage driver, but the voltage covered by the selected constant current driver.
- Take suitable ESD measures to avoid touching bare conductors.
- LED chips can be damaged if be in touch with chemical material or gas. Therefore, it is not allowed to clean the LED housing or luminaire by chemicals.
- The following items are confirmed to have negative impact on the performance of the luminaire, avoid to keep luminaire in the same circumstance with them.
 - Methyl acetate or ethyl acetate (i.e., nail polish remover)
 - Cyanoacrylates (i.e., "Superglue")
 - Glycol ethers (including Radio Shack ® Precision Electronics
 - Cleaner - dipropylene glycol monomethyl ether)
 - Formaldehyde or butadiene (including Ashland PLIOBOND ® adhesive)
 - Dymax 984-LVUF conformal coating
 - Loctite Sumo Glue、 Loctite 384 adhesive、 Loctite 7387 activator
 - Gorilla Glue、 Bleach, Bleach-containing cleaners, sprays
- Remove the insulation material from the luminaire or provide enough space so that the temperature raising will not overpass the limited TC.
- LED chip is very sensitive to switching transients, therefore, LED lamps and appliances must be connected after power cut off, no hotswappable.
- Recommends using the driver indicated on the luminaire manual.
- Must consider the polarity of the product.
- If the external flexible cable or cord of this lamp is damaged, the cord should be replaced by the manufacturer or its service agent or a similarly qualified person
- The light source in this lamp should be replaced by the manufacturer or its service agent or a similarly qualified person

4.