

LINA-F series installation instructions

1.

Series	Dimension(mm)
LS00402	(100/300/500/1000) x24x39

size:

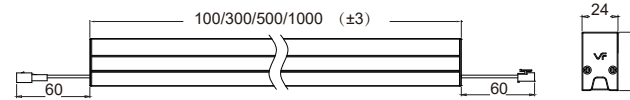
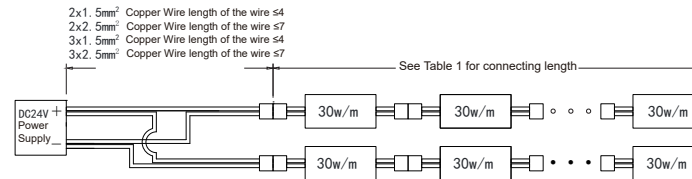

Table 1: The connecting length of each power

Power	20w/m	30w/m
Max length	5m	4m
Mounting	Surface Mount, Recessed Mount, Suspension Mount	Recessed Mount, Suspension Mount



**CAUTION:**

- 1、 The wiring diagram is for standard or turnable white lamps
- 2、 Taking the 30W/m lamp as an example, the maximum 4 meters of lamps can be connected in series, and the total power of each circuit does not exceed 120W. For lamps over this power, additional independent circuit should be added.

2.

**CAUTION-DC 24V Power Supply Installation:**

- To avoid electric shock, disconnect electrical power before and during installation
- Installation needs to be firm and reliable
- Wiring according to the marking on the power terminal or connecting line
- Do not reverse polarity when connecting
- Make sure all connections are reliable and in good contact
- Make sure all connections are insulated
- It is recommended to reserve 20% of power supply

**Surface Mount:**

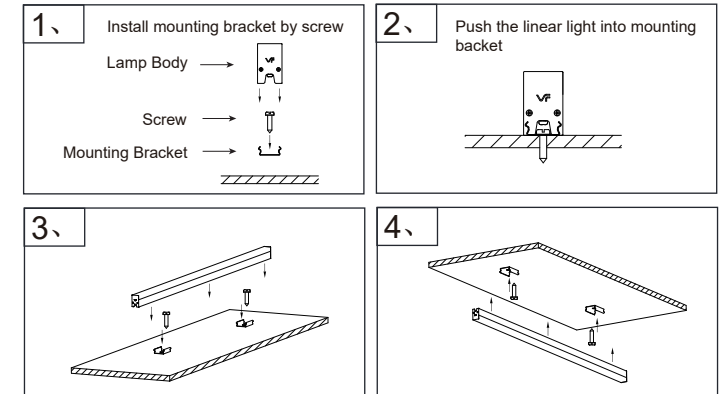

3.

### Recessed Mount:

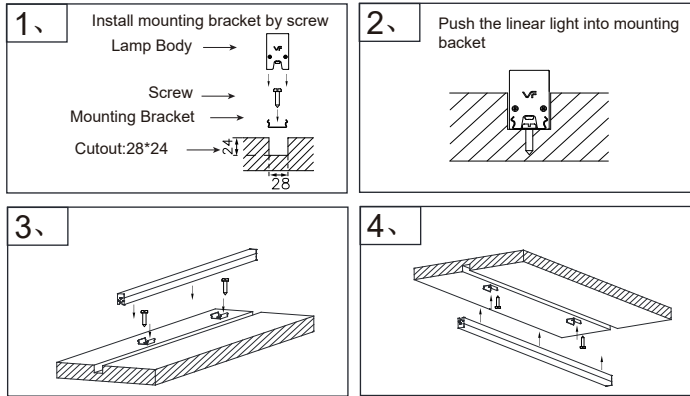

### Suspension Mount:

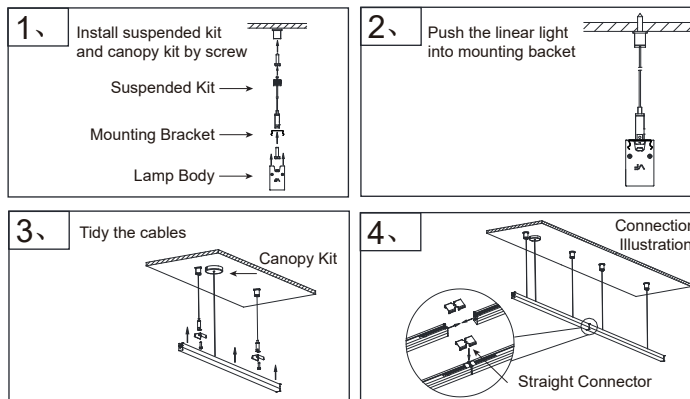

4.

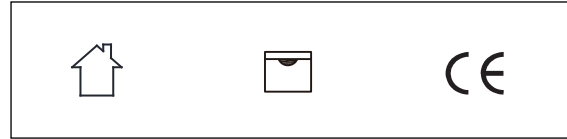

 The LED luminaire is installed indoor not outdoor.  
It is not allowed to be rinsed with water.

5.

Do not clean LED chip and reflector with hand or towel !



- Use only drivers that comply with IEC or CE safety standards.
- Check if the power supply match with the luminaire.
- Must consider the maximum current value displayed on the label of the luminaire.
- The voltage displayed on the luminaire is not used to select the constant voltage driver, but the voltage covered by the selected constant current driver.
- Take suitable ESD measures to avoid touching bare conductors.
- LED chips can be damaged if be in touch with chemical material or gas. Therefore, it is not allowed to clean the LED housing or luminaire by chemicals.
- The following items are confirmed to have negative impact on the performance of the luminaire, avoid to keep luminaire in the same circumstance with them.
  - Methyl acetate or ethyl acetate (i.e., nail polish remover)
  - Cyanoacrylates (i.e., "Superglue")
  - Glycol ethers (including Radio Shack @ Precision Electronics Cleaner - dipropylene glycol monomethyl ether)
  - Formaldehyde or butadiene (including Ashland PLIOBOND @ adhesive)
  - Dymax 984-LVUF conformal coating
  - Loctite Sumo Glue - Loctite 384 adhesive - Loctite 7387 activator
  - Gorilla Glue - Bleach, Bleach-containing cleaners, sprays
- Remove the insulation material from the luminaire or provide enough space so that the temperature raising will not overpass the limited TC.
- LED chip is very sensitive to switching transients, therefore, LED lamps and appliances must be connected after power cut off, no hotswappable.
- Recommends using the driver indicated on the luminaire manual.
- Must consider the polarity of the product.
- If the external flexible cable or cord of this lamp is damaged, the cord should be replaced by the manufacturer or its service agent or a similarly qualified person
- The light source in this lamp should be replaced by the manufacturer or its service agent or a similarly qualified person

6.