

LINA12

Lina series installation instructions

1.

SERIES	Length (mm)
LS00401	100、300、500、 1000、1200

— Installation instruction flush vecessed installation
(1) Only applicable to wood:

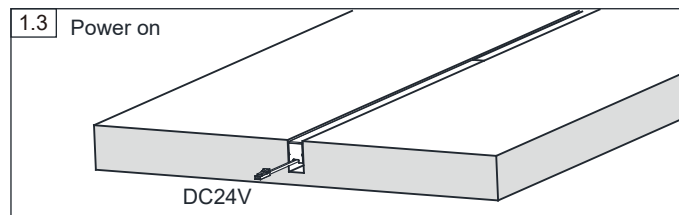
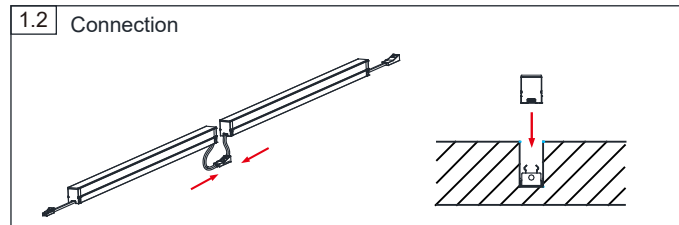
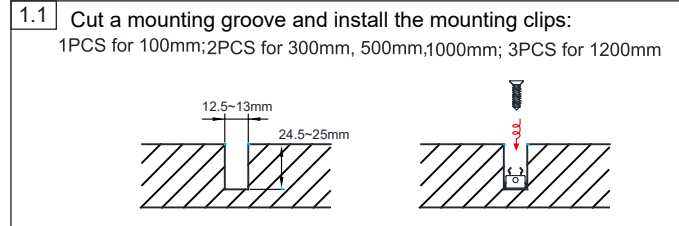

2.

(2) Surface mounted installation (suitable for wood and plasterboard)

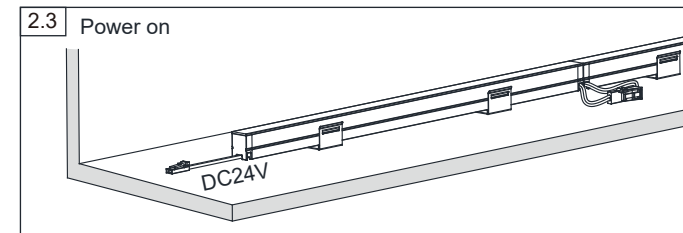
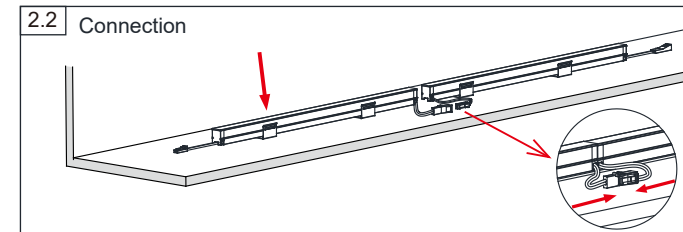
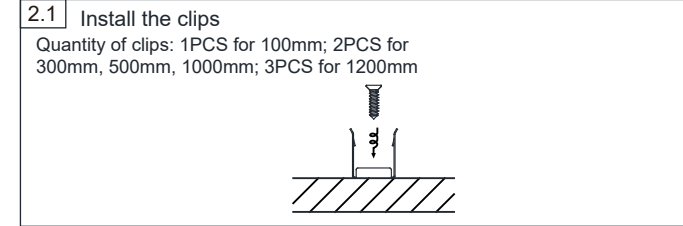

3.

(3) Surface Mounted Installation (suitable for marble and glass surface)

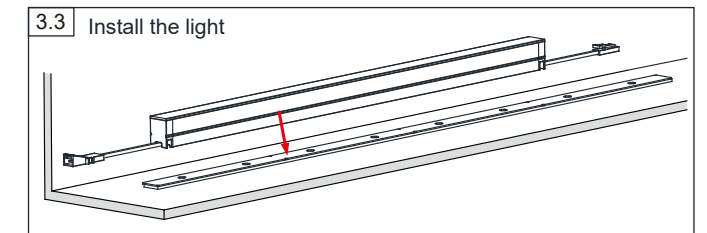
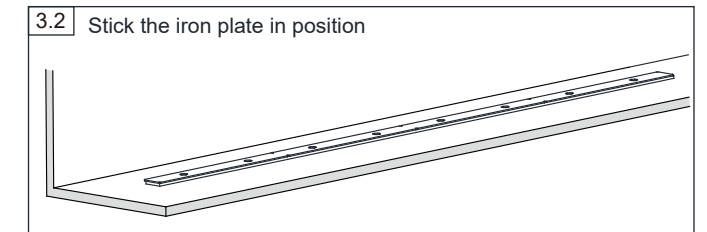
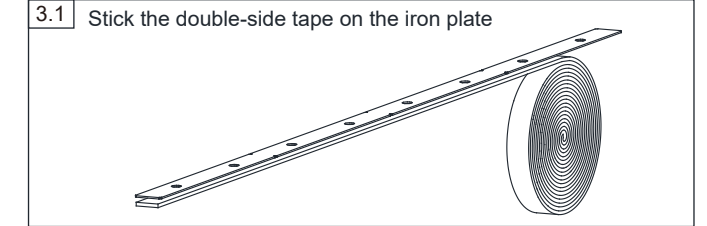

4.

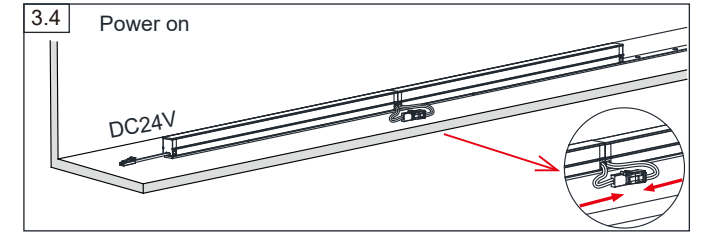

The specific appearance is subject to the real object!

INSTALLATION STEP

lamp with wiring diagram

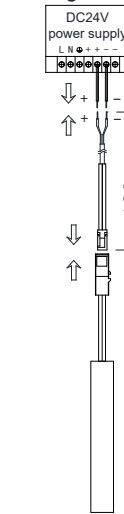

Notice for installing DC24V power supply:

- Power off when handling the installation.
- To firmly fix the power supply, make it reliable.
- To connect the wire as per the markings on connectors or lines.
- Pay attention to the polarity when connecting power supply and strip.
- Carefully connect every terminals, to make a good contact.
- Carefully connect every connectors of lines.
- Carefully make insulation after the connecting of every joints.
- To keep minimum 20% space for output power, See table 1 for strip number that can be afford to various power source.

Safety Instructions:

1. To fasten the LED strip.
2. To fasten the DC24V power supply.
3. To joint and firmly screw the strip connector.
4. To connect the strip and electric cord.
5. Connect DC24V power input to main power.
6. To double check.
7. Power on.

5.

Table 1: The maximum number of light that can be connected to the driver.

LED power Number of connected	Power supply			
	5 W/m	10W/m	15W/m	20W/m
30W	5m	2.5m	1.5m	1.2m
60W	10m	5m	3m	2.4m
100W	16m	8m	5m	4m
150W	25m	12m	8m	6m
200W	30m	16m	11m	8m

Table 2: sectional area of wire and maximum connection length of wire Lmax

--Suitable for splicing power less than 30W and mode A connection

LED power Max Lmax	Wire section			
	5W/m	10W/m	15W/m	20W/m
2 × 1.5mm ²	30m	15m	15m	20m
2 × 2.5mm ²	45m	25m	25m	30m

Note: the wire conductor listed in the above table is copper wire, and the working environment temperature is 30 °C

Table 3: sectional area of wire and maximum length of wire Lmax

--Connection for mode B

LED power Max Lmax	Wire section				
	24W	48W	80W	120W	160W
2 × 1.5mm ²	13m	6m	4m	2m	2m
2 × 2.5mm ²	21m	10m	6m	4m	3m

Note: The total power of the lamp strip is the sum of the power of all lines. The total power of lamp strip= line1+line...+lineN*” Means not allowedThe electric conductors listed above are copper wire. Working temperature range is 30°C

Wiring diagram of light belt and DC24V power supply

1. Total power of light bar splicing < 30W

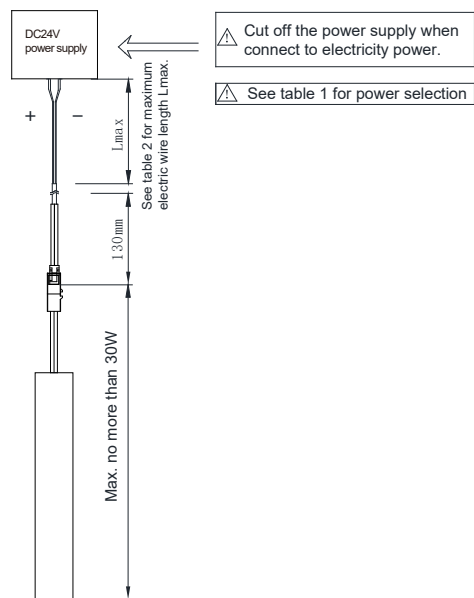

2. Total power of light bar splicing ≥ 30W ---Mode A

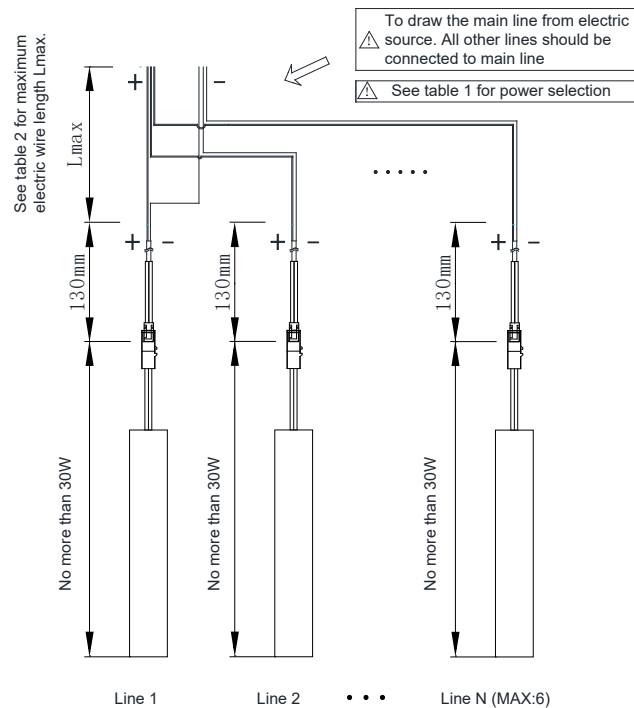

3. Total power of light bar splicing ≥ 30W ---Mode B

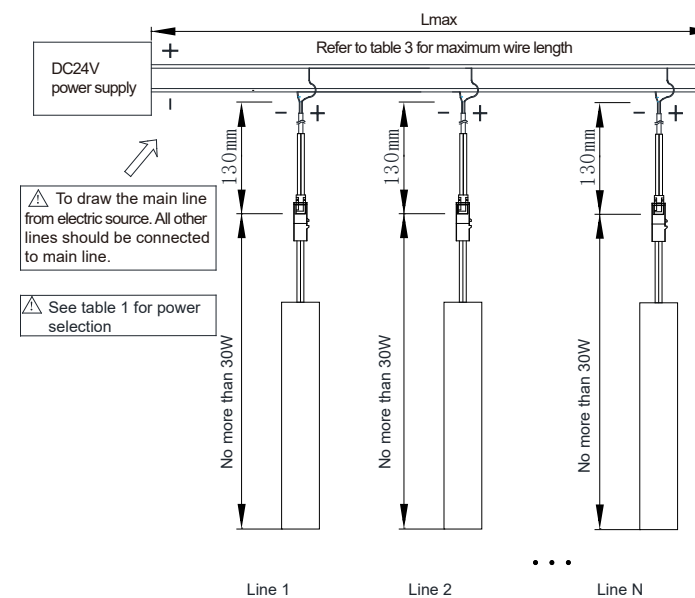

⊞ Precautions and cleaning instructions

The LED module is not replaceable. The safety performance of the light strip can only be guaranteed by strictly following the following installation instructions, so it is necessary to properly Keep this manual

During the installation, the installation of the light bar must be carried out under the condition that the current is cut off.

Under no circumstances shall the lamp bar be changed or used forcefully, and any change will affect the lamp The safety performance of clause makes it dangerous. VF shall not bear any responsibility for the changed products.



This product should be eliminated in a different way from other urban wastes after being discarded. In case of product failure, professional personnel shall be invited for maintenance, and disassembly is not allowed.

The lamp bar shall not be directly connected to the mains supply, and the power supply indicated in the instruction manual shall be used.

After the lamp strips have cooled down, clean them with only a soft cloth.

If the dirt is stubborn, use soapy water or neutral detergent to wet the soft cloth.

Warning: please do not use alcohol or corrosive diluents to contact the light bar!

-  This product can only be installed in indoor environment, not in contact with water!
-  The lamp strip shall not be covered with insulation gasket or similar materials!
-  Do not throw it into the garbage can at will. Please recycle it professionally.