



① Plastic tape
SK-SL-AL10



② Steel Belts
SK-SL-BL10



Basic Accessories
SK-SL

- ③ Screw Rods
- ④ Swivel Rod
- ⑤ Base box
- ⑥ Wiring terminals
- ⑦ Screws
- ⑧ Rubber plugs
- ⑨ Hexagon screwdriver

Toolkit
SK-SL-0001



Scissors

Gloves

Installation steps

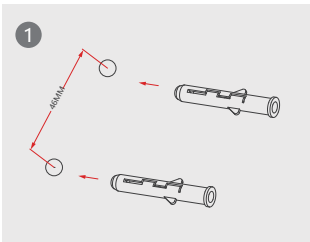

1 Drill 2 holes of 6mm diameter in the installation wall, with a distance of 42mm between the two holes, and install the plastic expansion tube.

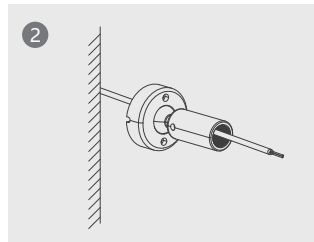

2 The wire connecting DC24V passes through the bottom box and the swivel rod.

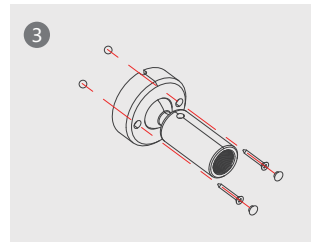

3 Put the screw rod through the base box, fix the base box to the wall, and please fix the rotating rod with wire to the terminal of the bottom box.

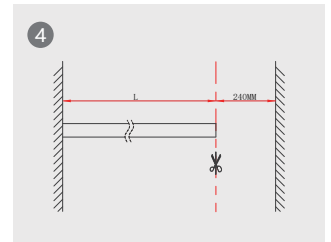

4 Measure the distance of the installation wall, the cut length of the plastic strip (steel strip) should be 240mm shorter than the measured length L.

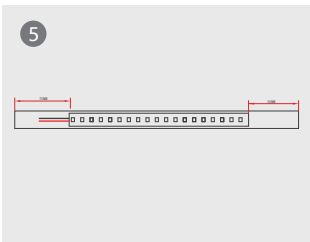

5 Attach the LED strip to the plastic strip (steel strip), leaving 70mm at the beginning and 50mm at the end.

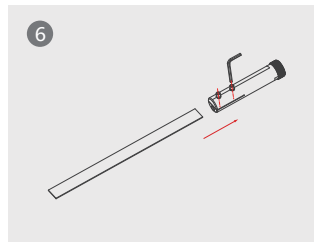

6 Fix the plastic band (steel band) to the screw rod.

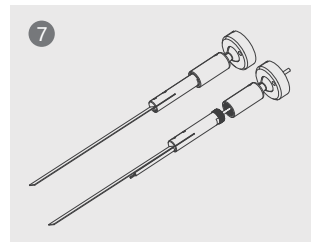

7 First fix the screw rod with the LED strip outlet end, then fix the other end screw rod.

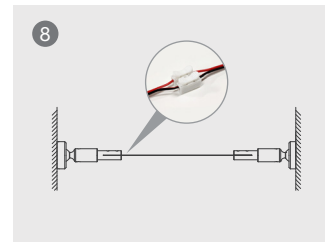

8 Connect both sides of the outgoing wires to the pressed quick terminals.

Installation Guidelines

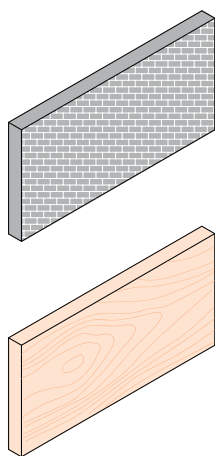
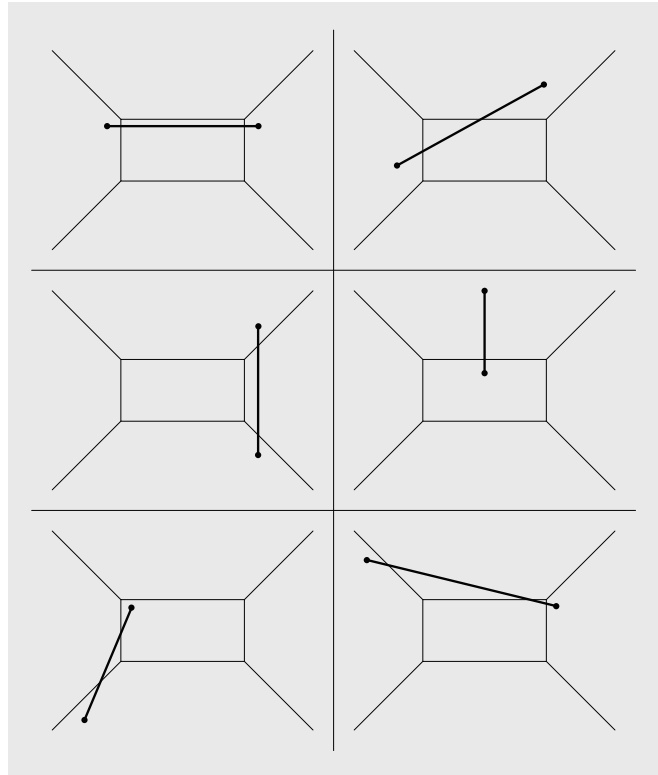
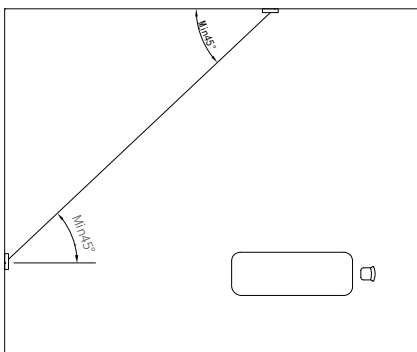
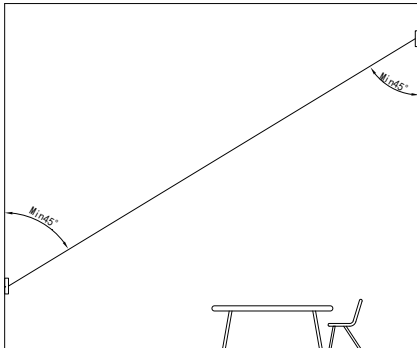

Brick Wall

Wood

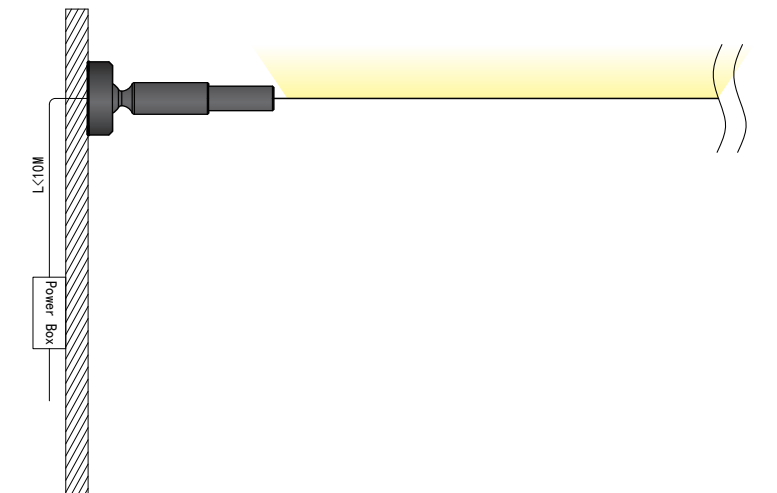

Caution.

- 1, To install the product in a suitable environment, the installation surface must be solid wood walls, concrete walls, or brick walls, please do not install in a plaster wall or hollow wall surface;
- 2, While installing and cutting the steel belt, please match the goggles and protective gloves, steel belt has elasticity, please confirm the safety of the case to open the steel belt packaging;