

Nicole Series Installation Instructions

1.

Specification:

Model	Size	Model	Size
Reflector Type II	$\Phi 90 \times 250\text{mm} \setminus \Phi 90 \times 500\text{mm} \setminus \Phi 90 \times 750\text{mm}$	Upper	$\Phi 90 \times 250\text{mm} \setminus \Phi 90 \times 500\text{mm} \setminus \Phi 90 \times 750\text{mm}$
Reflector	$\Phi 90 \times 250\text{mm} \setminus \Phi 90 \times 500\text{mm} \setminus \Phi 90 \times 750\text{mm}$	Diffuse	$\Phi 90 \times 250\text{mm} \setminus \Phi 90 \times 500\text{mm} \setminus \Phi 90 \times 750\text{mm}$
Louver	$\Phi 90 \times 250\text{mm} \setminus \Phi 90 \times 500\text{mm} \setminus \Phi 90 \times 750\text{mm}$	Disk	$\Phi 140 \times 250\text{mm} \setminus \Phi 140 \times 500\text{mm} \setminus \Phi 140 \times 750\text{mm}$

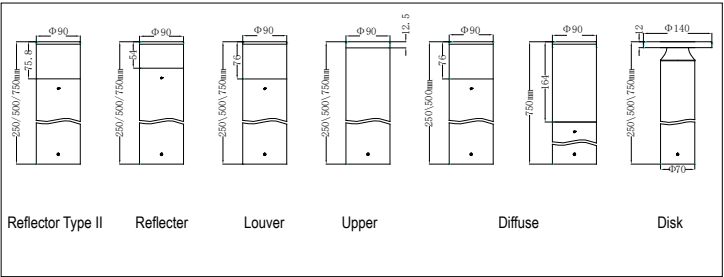

Base installation:

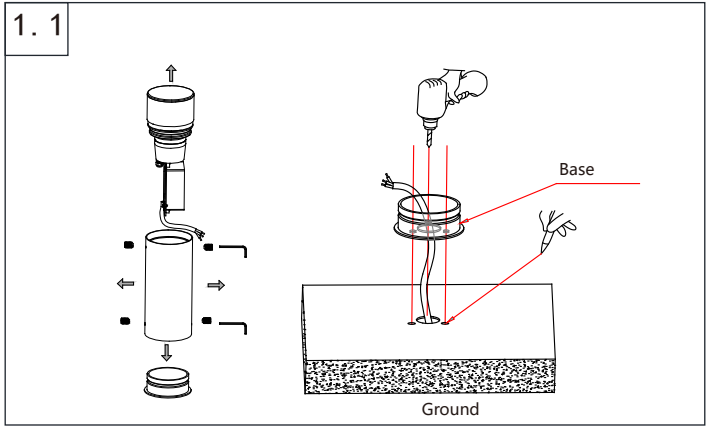

2.

1. 2

Expansion bolt recommendation
specification: M6xL80mm

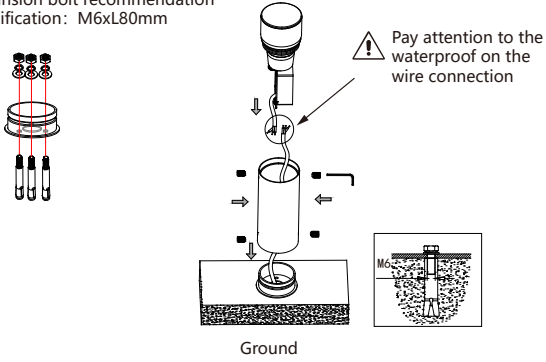

Embedded installation:

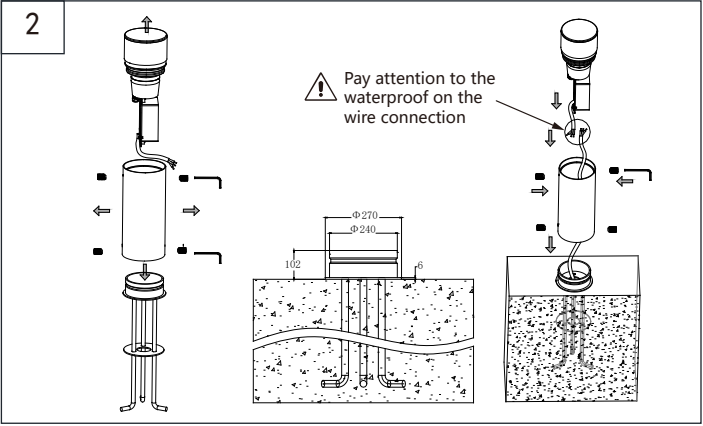

3.

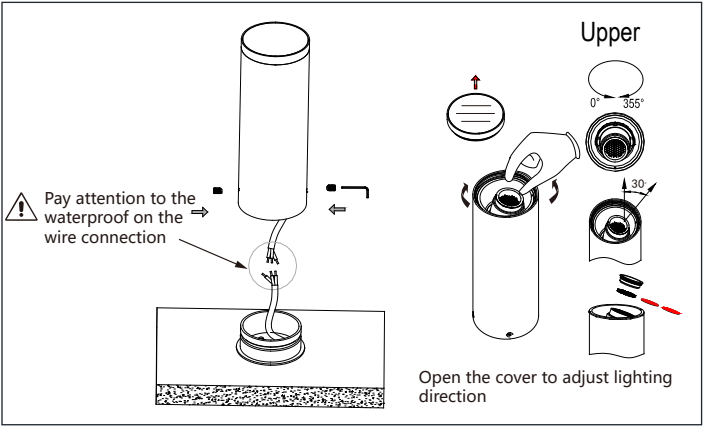
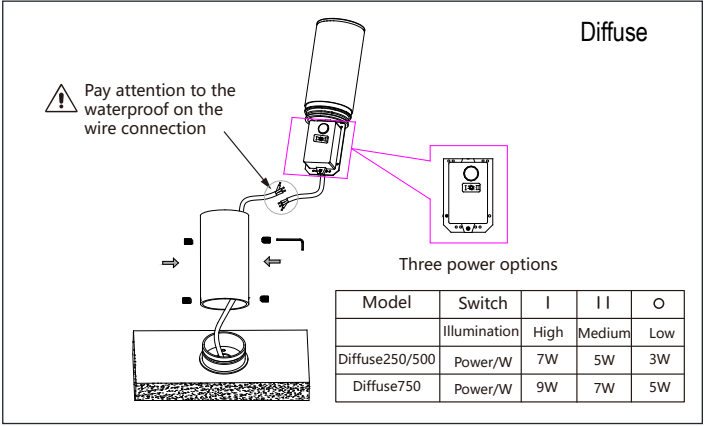

4.

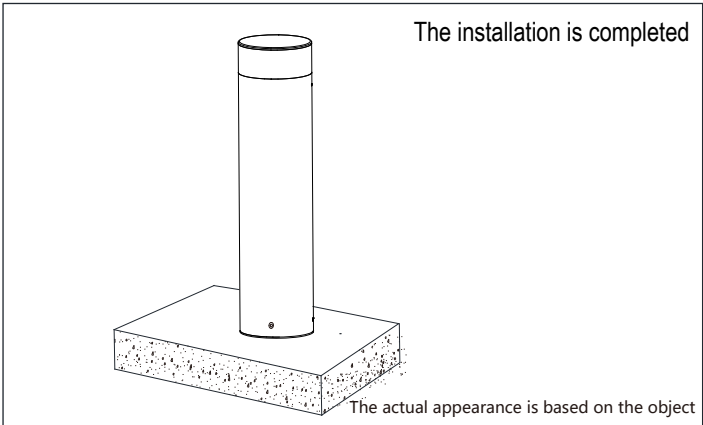
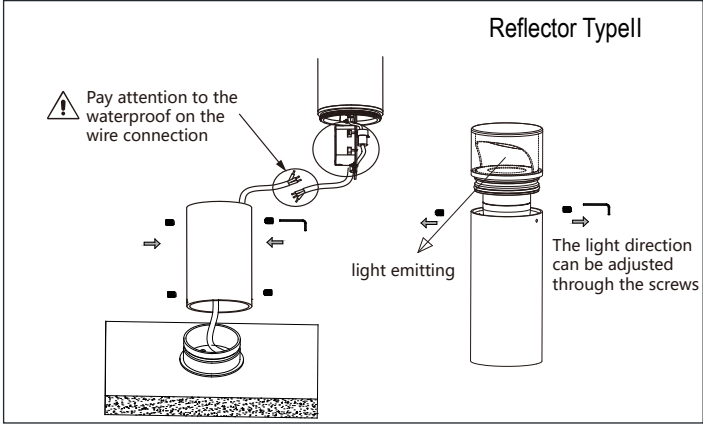

The output wire instruction:

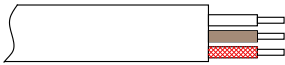
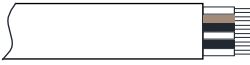
Three core cord (for non dim or phase dim)	Five core cord (for DALI/0-10V dim)
	
brown: AC 220V L blue: AC 220V N yellow and green: GND	brown: AC 220V L blue: AC 220V N yellow and green: GND red: DIM + black: DIM -

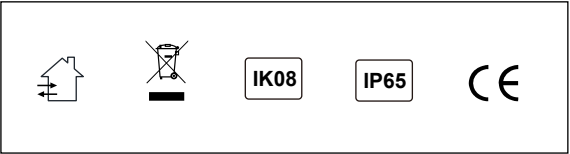

Suitable for indoor and outdoor environment.

- Use only drivers that comply with IEC or CE safety standards.
- Check if the power supply match with the luminaire.
- Must consider the maximum current value displayed on the label of the luminaire.
- The voltage displayed on the luminaire is not used to select the constant voltage driver, but the voltage covered by the selected constant current driver.
- Take suitable ESD measures to avoid touching bare conductors.
- LED chips can be damaged if be in touch with chemical material or gas. Therefore, it is not allowed to clean the LED housing or luminaire by chemicals.
- The following items are confirmed to have negative impact on the performance of the luminaire, avoid to keep luminaire in the same circumstance with them.
 - Methyl acetate or ethyl acetate (i.e., nail polish remover)
 - Cyanoacrylates (i.e., "Superglue")
 - Glycol ethers (including Radio Shack ® Precision Electronics Cleaner - dipropylene glycol monomethyl ether)
 - Formaldehyde or butadiene (including Ashland PLIOBOND ® adhesive)
 - Dymax 984-LVUF conformal coating
 - Loctite Sumo Glue, Loctite 384 adhesive, Loctite 7387 activator
 - Gorilla Glue, Bleach, Bleach-containing cleaners, sprays
- Remove the insulation material from the luminaire or provide enough space so that the temperature raising will not overpass the limited TC.
- LED chip is very sensitive to switching transients, therefore, LED lamps and appliances must be connected after power cut off, no hotswappable.
- Recommends using the driver indicated on the luminaire manual.
- Must consider the polarity of the product.
- If the external flexible cable or cord of this lamp is damaged, the cord should be replaced by the manufacturer or its service agent or a similarly qualified person
- The light source in this lamp should be replaced by the manufacturer or its service agent or a similarly qualified person